



POINT WEST

For lease:
NWC Belt Line Rd &
I-635
Coppell, TX 75019

VENTURE

AMY PJETROVIC
APJETROVIC@VENTUREDFW.COM

NATALIA SINGER
NSINGER@VENTUREDFW.COM

MIA UREÑA
MURENA@VENTUREDFW.COM

Metrics

NWC Belt Line Rd & I-635
Coppell, TX 75019

Available Spaces

Lot 1 Lot 6 Lot 2
1,326 SF 1,546 SF 1,391 SF

Lot 5
1,480 SF

Pads
1. 1.78 AC Hard corner for ground lease or BTS
2. 1.02 AC
3. 0.856 AC
4. 1.13 AC

Traffic Counts

Belt Line Rd I-635
35,554 VPD 97,451 VPD

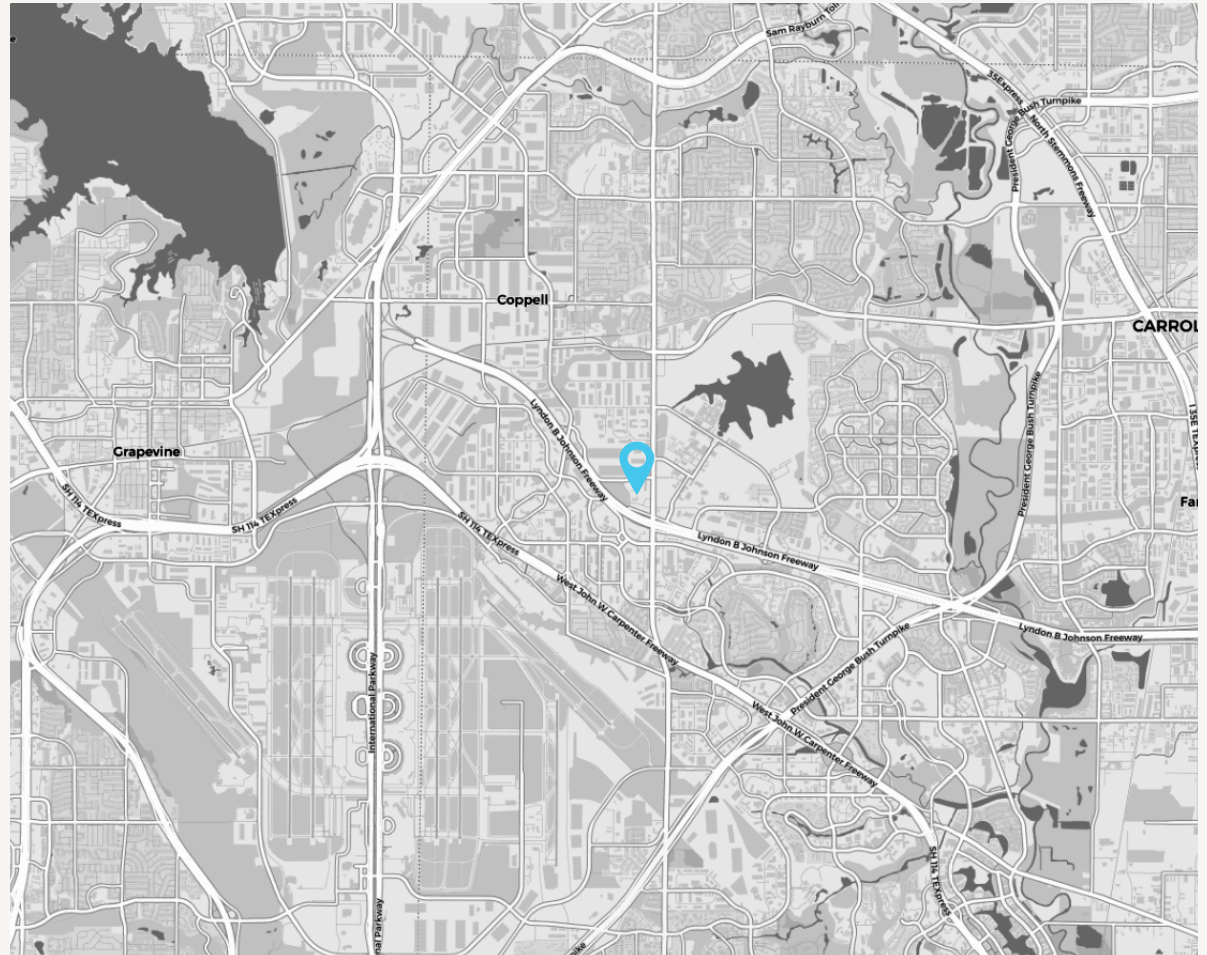

Area Attractions



PARIS BAGUETTE



VENTURE

AMY PJETROVIC
APJETROVIC@VENTUREDFW.COM

NATALIA SINGER
NSINGER@VENTUREDFW.COM

MIA UREÑA
MURENA@VENTUREDFW.COM

Property Highlights

NWC Belt Line Rd & I-635
Coppell, TX 75019

1. Located at the hard corner of Hwy 635 & Belt Line with over 130,000 cars per day
2. New HEB under construction directly east of the site
3. Cypress Waters is a 1,000 acre development with over 3.6 million sf of office existing (6.5 million at full completion) and 1,300 apartment units existing (10,000 at full completion)
4. High daytime population and high average HH income



2025 Demographic Summary

	1 MILE	3 MILES	5 MILES
EST. POPULATION	2,721	65,274	183,302
EST. DAYTIME POPULATION	24,343	102,432	214,927
EST. AVG. HH INCOME	\$162,311	\$175,844	\$152,847

Site Plan

NWC Belt Line Rd & I-635
Coppell, TX 75019

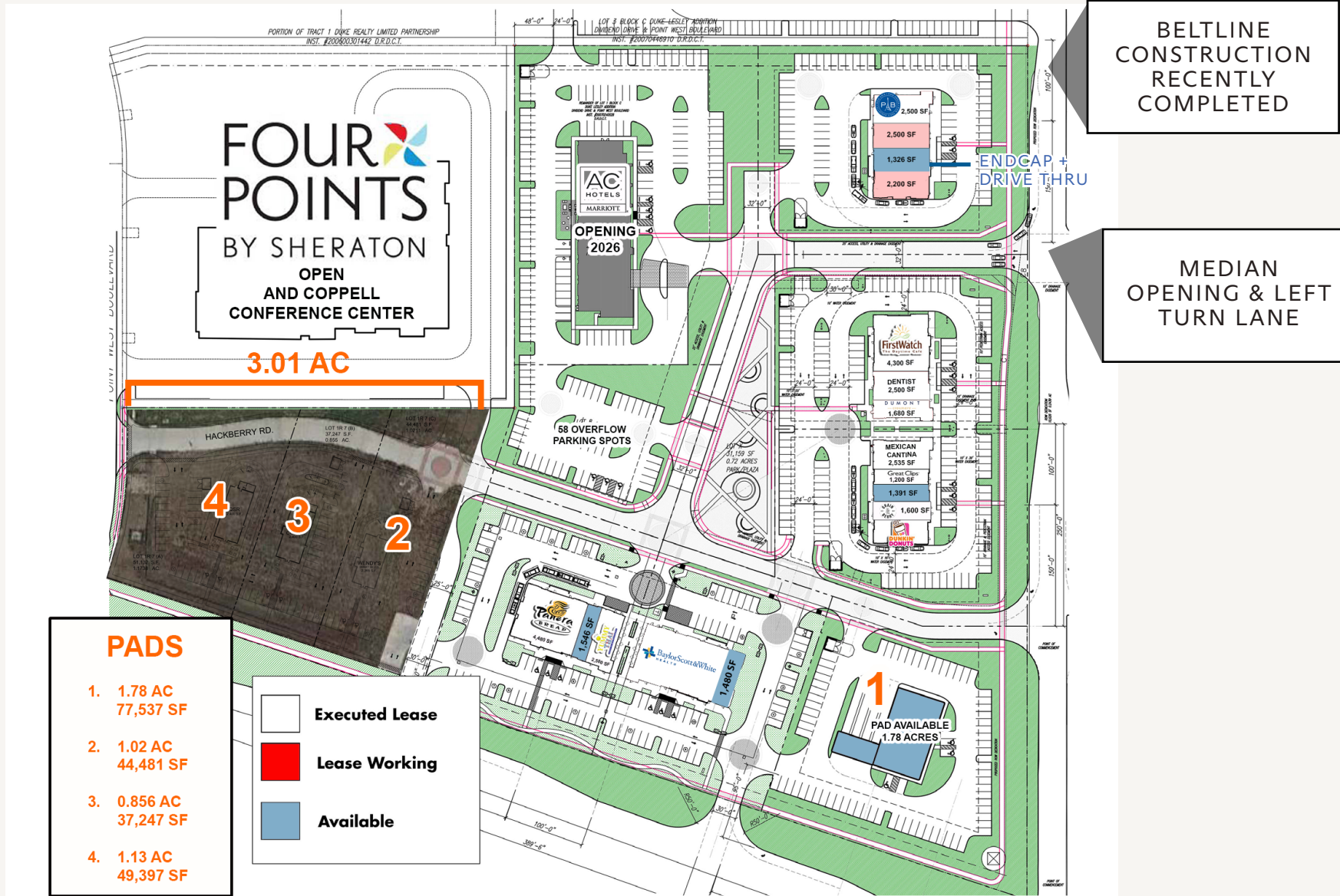

Lot 1 Plan

NWC Belt Line Rd & I-635
Coppell, TX 75019

END CAP
DRIVE THRU

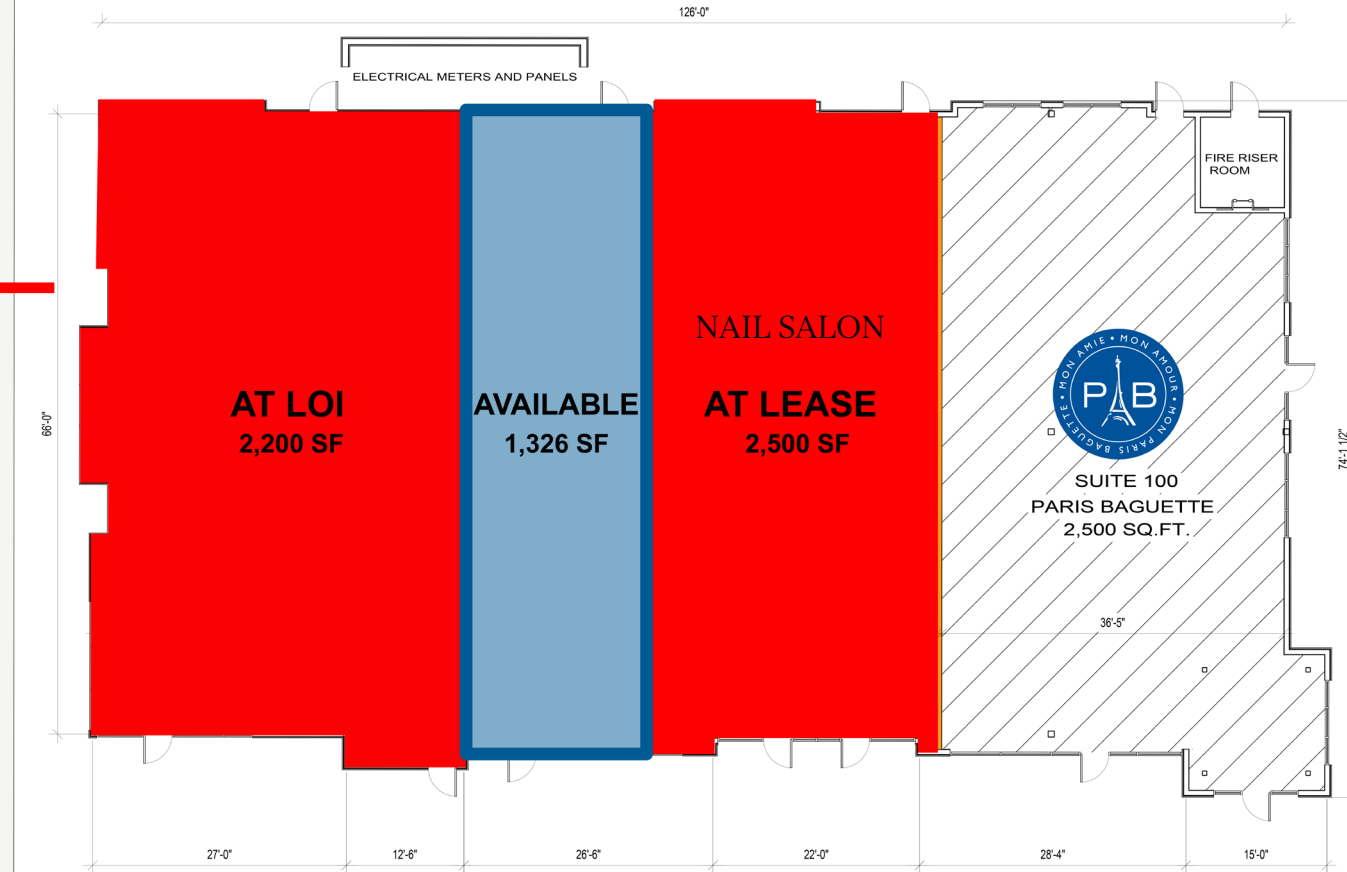

FLOOR PLAN
SCALE: 3/16" = 1'-0"

GLA: 8,526 SF

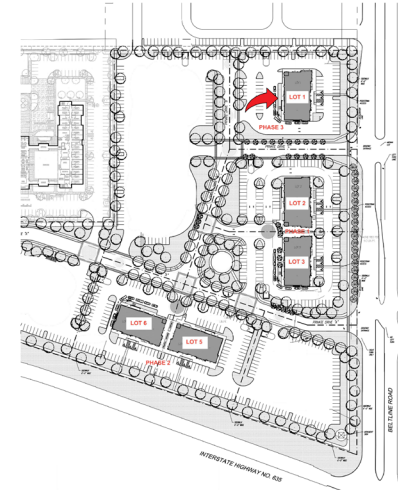

CIVIL PLANS: OCTOBER 2018

LOT 1 - PHASE 3
POINT WEST DEVELOPMENT
1535 S. BELTLINE, COPPELL, TEXAS

Lot 3 Plan

NWC Belt Line Rd & I-635
Coppell, TX 75019

GLA: 8,526 SF

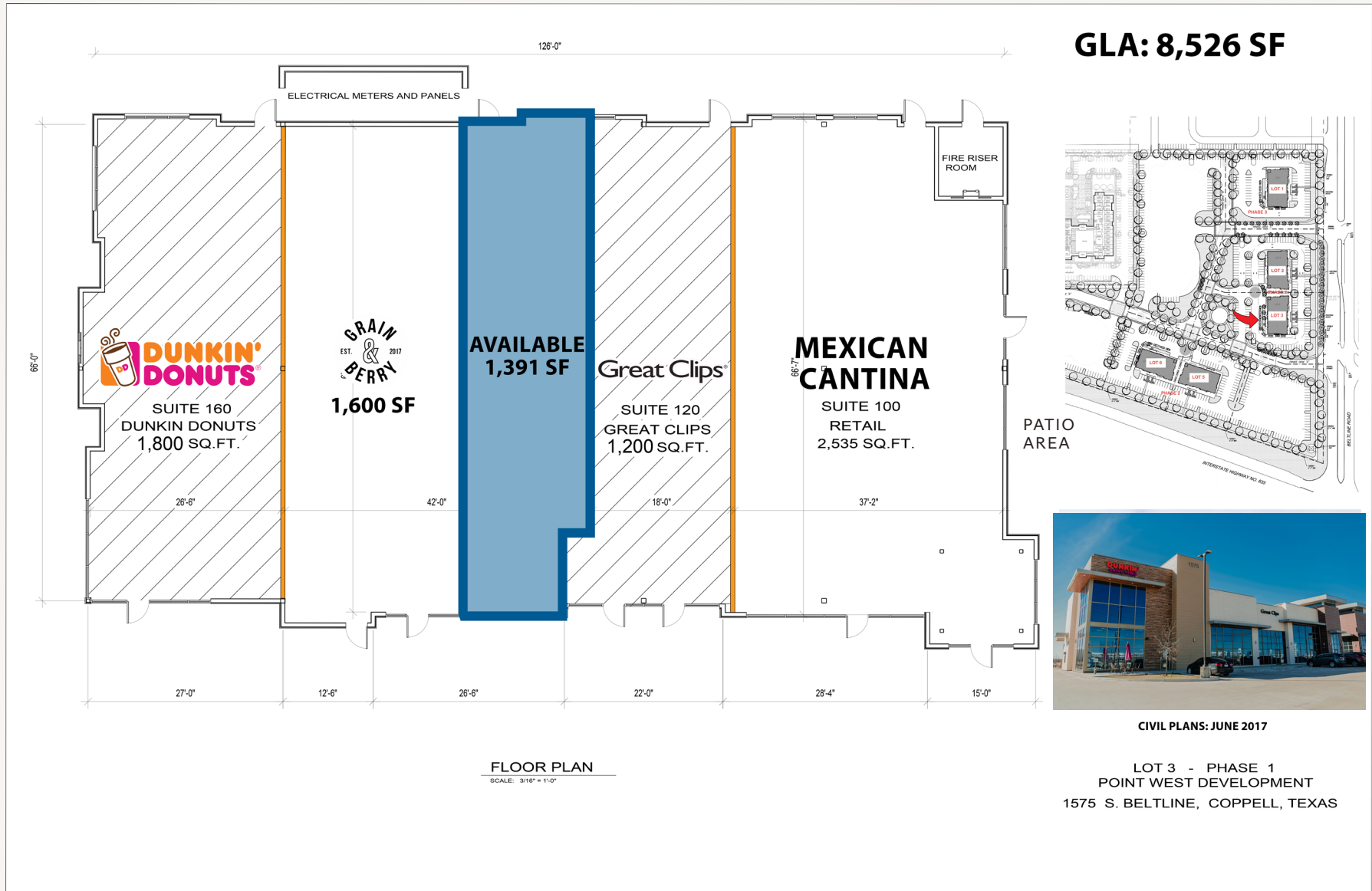

Lot 5 Plan

NWC Belt Line Rd & I-635
Coppell, TX 75019

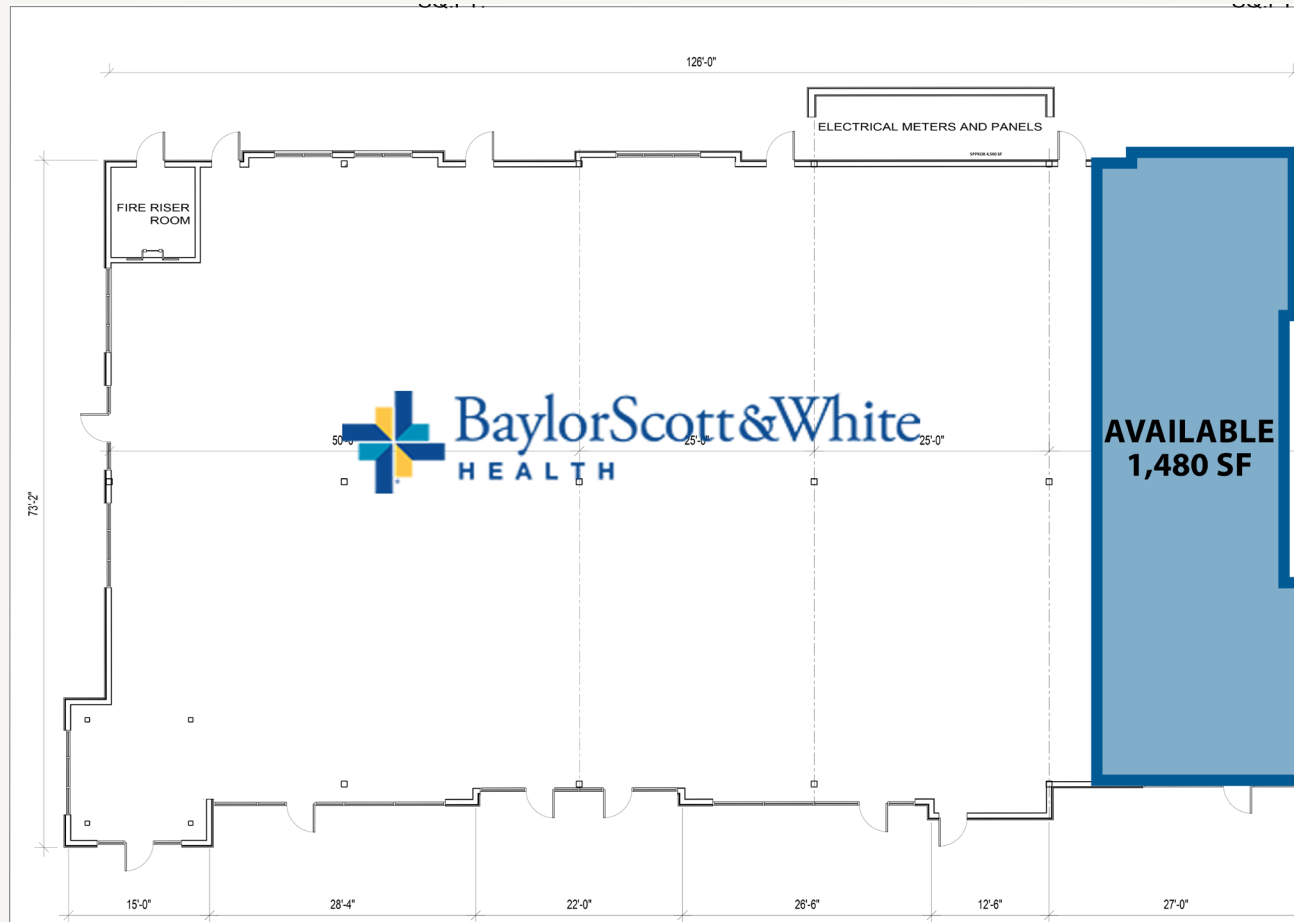

FLOOR PLAN
SCALE: 3/16" = 1'-0"

GLA: 8,480 SF

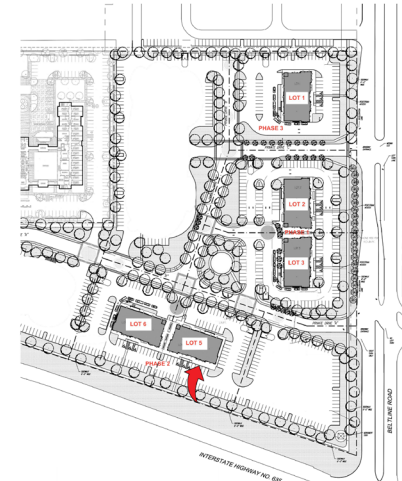

CIVIL PLANS: MAY 2018

LOT 5 - PHASE 2
POINT WEST DEVELOPMENT
120 W. LBJ FWY. - COPPELL, TEXAS

Lot 6 Plan

NWC Belt Line Rd & I-635
Coppell, TX 75019

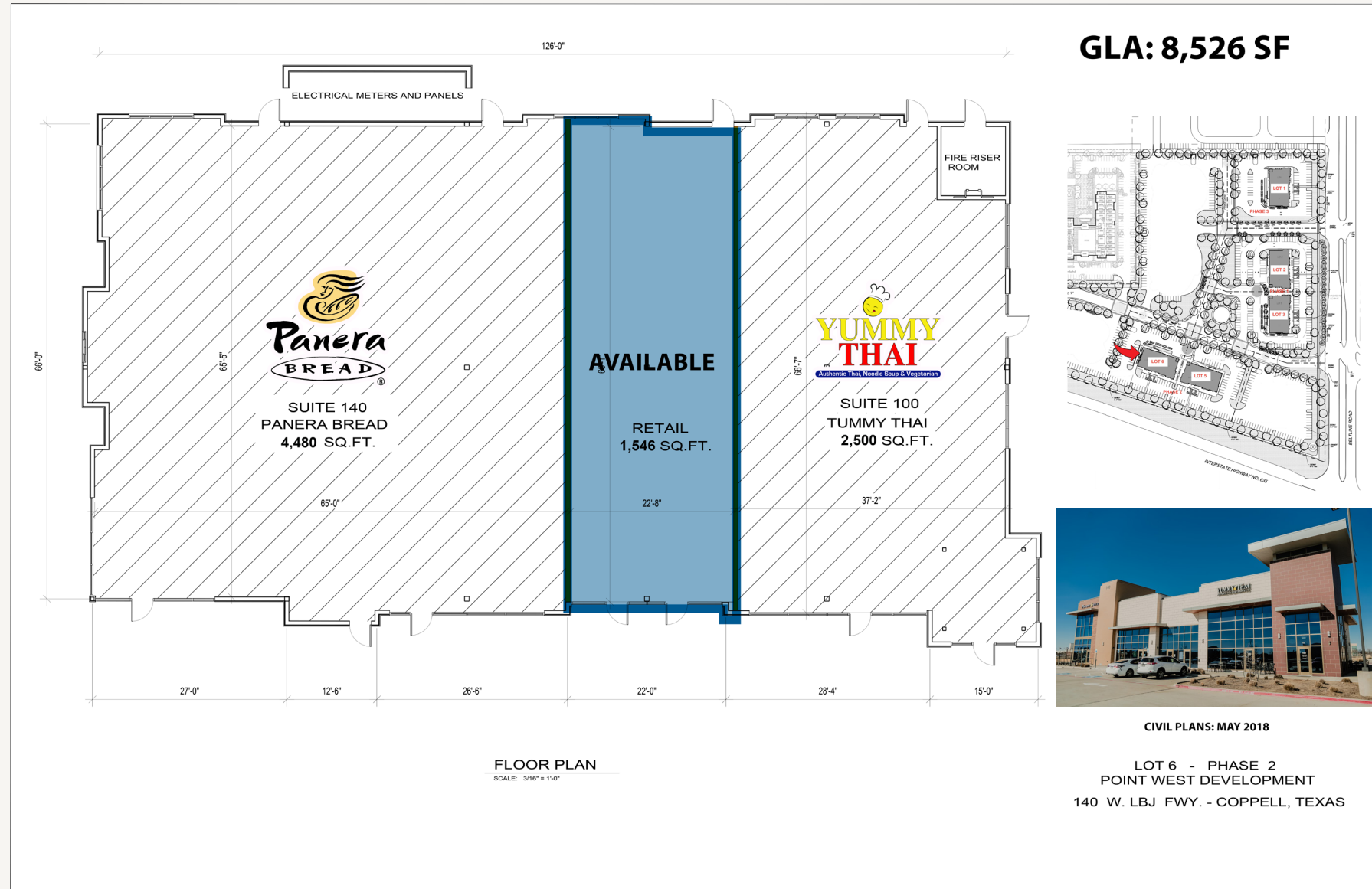

Aerial

NWC Belt Line Rd & I-635
Coppell, TX 75019



Photos

NWC Belt Line Rd & I-635
Coppell, TX 75019



VENTURE

AMY PJETROVIC
APJETROVIC@VENTUREDFW.COM

NATALIA SINGER
NSINGER@VENTUREDFW.COM

MIA UREÑA
MURENA@VENTUREDFW.COM

NWC Belt Line
Rd & I-635
Coppell, TX 75019

Amy Pjetrovic
Principal

apjetrovic@venturedfw.com

Natalia Singer
Senior Vice President

nsinger@venturedfw.com

Mia Ureña
Transaction Manager

murena@venturedfw.com

(214) 378-1212

www.VentureDFW.com

8235 Douglas Ave
Suite 720
Dallas, Texas 75225

VENTURE

*The information contained herein was obtained from sources deemed reliable; however, Venture Commercial Real Estate, LLC, makes no guarantees, warranties or representations as to the completeness or accuracy thereof. The presentation of this property is subject to errors; omissions; change of price, prior to sale or lease; or withdrawal without notice.

